

50m - 1.250kg

45m - 1.500kg

40m - 1.800kg

33m - 2.200kg

28m - 2.500kg

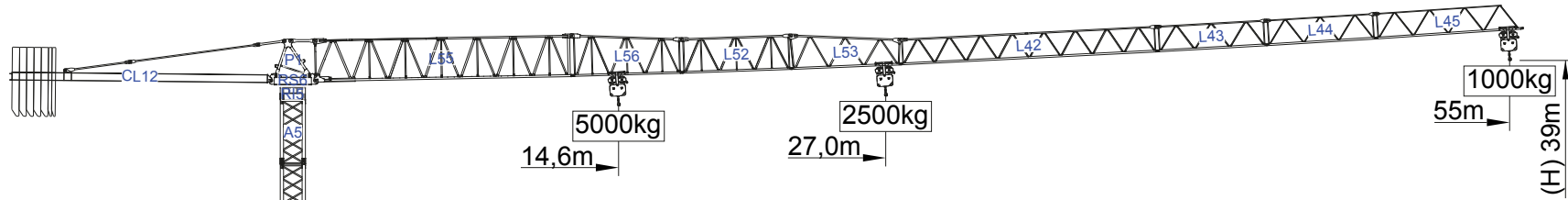

Cargas.Loads.Lasten.Charges.Cargas.Carichi.Yükler. ГРУЗОПОДЪЕМНОСТЬ

Icon	Jib Diagram	Kg/m 5000 M/CT 2500	m	Jib Length (m)										
				13	18	23	28	33	40	45	50	55		
12000 kg 5x2000 + 2x1000 kg	55m	27 m	2500	2500	2500	2500	2500	1970	1540	1320	1150	1000		
				14,6 m	5000	3980	3020	2400	1970	1540	1320	1150	1000	
11000 kg 5x2000 + 1x1000 kg	50m	28,8 m	2500	2500	2500	2500	2500	2130	1670	1440	1250			
				15,6 m	5000	4270	3340	2590	2130	1670	1440	1250		
9000 kg 4x2000 + 1x1000 kg	45m	29,7 m	2500	2500	2500	2500	2500	2210	1740	1500				
				16,1 m	5000	4420	3360	2680	2210	1740	1500			
8000 kg 3x2000 + 2x1000 kg	40m	30,5 m	2500	2500	2500	2500	2500	2280	1800					
				16,5 m	5000	4550	3460	2760	2280	1800				
7000 kg 3x2000 + 1x1000 kg	33m	29,6 m	2500	2500	2500	2500	2500	2200						
				16 m	5000	4540	3450	2760	2200					
6000 kg 2x2000 + 2x1100 kg	28m	28 m	2500	2500	2500	2500	2500	2200						
				15,2 m	5000	4180	3170	2500	2200					

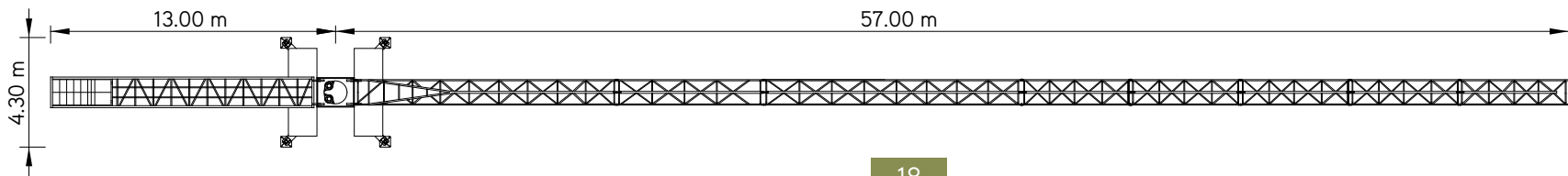
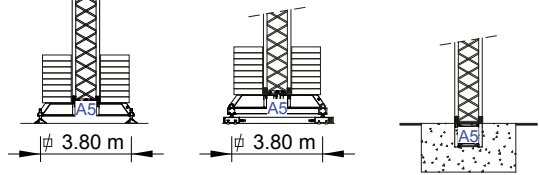





SGT 5510TL 2015

55m - 1.000kg

5.000Kg

Características . Characteristics . Eigenschaften
Caractéristiques . Characteristics . Caratteristiche
Özellikler . ХАРАКТЕРИСТИКИ

	
	0 a 1 r.p.m. 2x4 daN.m
	0 a 60 m/min 3 kW
	15 m/min 2x3 kW

	
	0 a 76 m/min 15 kW
	0 a 38 m/min

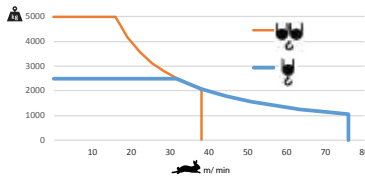





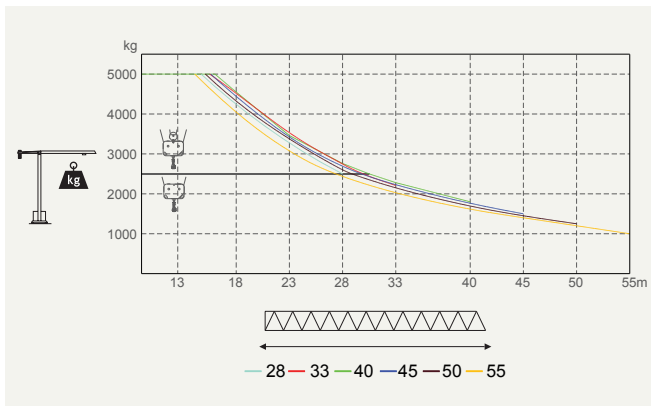





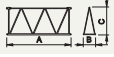

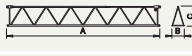

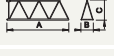

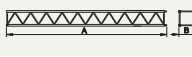
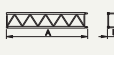

	30 kVA
	400 V +- 5% (50/60 Hz)

Velocidade de elevação . Hoisting speed . Hubgeschwindigkeit . Vitesse d'élevation .
Velocidad de elevación . Velocità di sollevamento . Kaldırma hızı (m/min) .
Скорость подъема (м/мин)



Elementos . Parts . Teile . Éléments . Elementos . Elemento . Parçalar . ЭЛЕМЕНТЫ

		A (mm)	B (mm)	C (mm)	kg	Code	
L55		11950	1210	2600	3100	509 55 10	
L56		5200	1160	1930	590		
L52		5200	1160	1650	535		
L53		5200	1160	1650	510		
L42		11820	1160	1210	820		
L43		5100	1160	1210	260		
L44		5100	1160	1210	230		
L45		6800	1160	1210	290		
RS6 RI5		2250	1350	2050	2640		
P1		1660	1220	1720	720		
CL12		12000	1380	560	2560		
CP3		1160	165	3140	2x1000 2000		704 15 00
CP2		1160	330	3140	5x2000 10000		704 20 00
TOTAL					24255		
A5		11985	1160	1160	3080	530 12 00	
A5		6075	1160	1160	1660	530 06 00	
A5		3120	1160	1160	990	530 06 01	
A5		3090	1385	1385	1040	530 06 03	
A5		1275	1160	1160	450	530 06 02	
A5		5530	500	750	1250	630 00 01	
		2270	360	750	2x635 1270		
TOTAL					2520		